

Accessories

We provide suitable accessories for your applications. Custom-made products and adaptations are available at short notice.

Quick change inserts Size 0 - 2

To mount taps in quick change tapping chucks.
The selection of the taps results out of shank diameter and square



[Size 0 \(Tauro® 25\)](#)



[Size 1 \(Tauro® 83 / 120 / Taurox® 300\)](#)



[Size 2 \(Taurox® 400 / 900\)](#)

Feed system for spindle

The feed is especially well suited for handling solutions and automation.

- step less adjustable limit for gating force with presentation in display
- step less adjustable speed of feed
- damping for low tool wear
- start by foot switch, sensor, or PLC interface (accessory)
- start on adjustable release height (time saving)

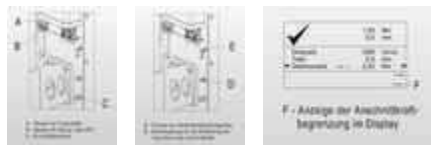

Foot switch, proximity switch for Feed system

- foot switch in standard design
- foot switch in robust design
- inductive proximity switch with plug

Minimum lubricant unit with lubricant pulse and air pulse

- pneumatic 87psi / 6bar
- adjustable dosage in the microliter range
- 2 vent to control
- without spray mist
- time and pulse adjustable by user interface unit
- very low usage of cooling lubricant



Minimum lubricant unit with lubricant pulse, air pulse and air cleaning pulse

- pneumatic 87psi / 6bar
- adjustable dosage in the microliter range
- 3 vents for separate control
- without spray mist
- time and pulse adjustable by user interface unit
- very low usage of cooling lubricant
- the final blow cleans after work process
- final blow control at the chip cleaning work mode



Signalbar for quality evaluation

- green, orange, red
- green means: Quality good, work process without errors
- orange means: Machine is working
- red means: Errors occurred during work process

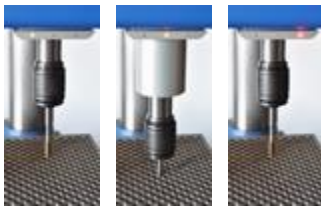

Signal light column for quality evaluation

- green, orange, red and horn
- green means: Quality good, work process without errors
- orange means: Machine is working
- red and horn (short signal) means: Errors occurred during work process



Key switch with lock-out

- locks the user interface
- locks the output signal of the clamping function in case of errors during work process



Additional push buttons selection for parameter data base

- direct access to saved parameter sets
- fast switch of tool
- assigning special functions (on demand)



Fixation to wall assembly kit for fixation to wall (control unit Tauro® 8/25/83)

- perpendicular mounting of the control unit
- little need of space for the control unit
- simple mounting

